

DUNBEG SOUTH  
EXTENSION  
**WIND FARM**  
**FIGURE 1.17**

**TEMPORARY SMALL CONSTRUCTION  
COMPOUND**

NOTES

- DO NOT SCALE FROM THIS DRAWING.
- SIZE, NUMBER AND LOCATION OF COMPOUND EQUIPMENT AND FACILITIES ARE INDICATIVE ONLY AND SUBJECT TO CHANGE TO SUIT SITE CONDITIONS.
- COMPOUND WILL BE CLEARED OF EQUIPMENT AND FACILITIES FOLLOWING COMPLETION OF CONSTRUCTION WORKS. HARDSTANDING WILL BE RETAINED DURING OPERATION FOR PUBLIC PARKING
- APPROPRIATE MEASURES FOR SEPARATION OF OILS AND TREATMENT OF FOUL WATER TO BE AGREED WITH THE RELEVANT AUTHORITIES
- VEHICULAR GATES TO BE 6m WIDE CONSISTING OF 2 x 3m LEAVES.
- COMPOUND HARDSTANDING TO CONSIST OF COMPACTED STONE OVER A LAYER OF GEOTEXTILE TO PROVIDE A CLEAN, FIRM, LEVEL AND FREE DRAINING SURFACE SUITABLE FOR CABINS/HEAVY TRAFFIC.
- FOLLOWING MOBILISATION OF THE MAIN CONSTRUCTION COMPOUND, THE ENABLING WORKS COMPOUND AREA WILL BE RETAINED FOR PARKING AND STORAGE DURING CONSTRUCTION.

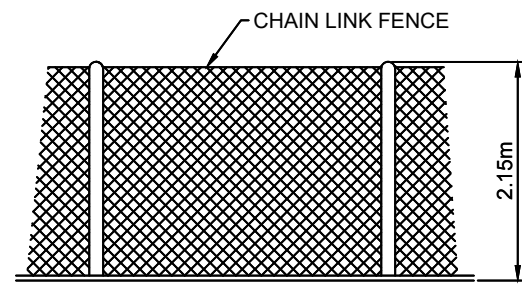

TYPICAL FENCE PANEL  
NTS

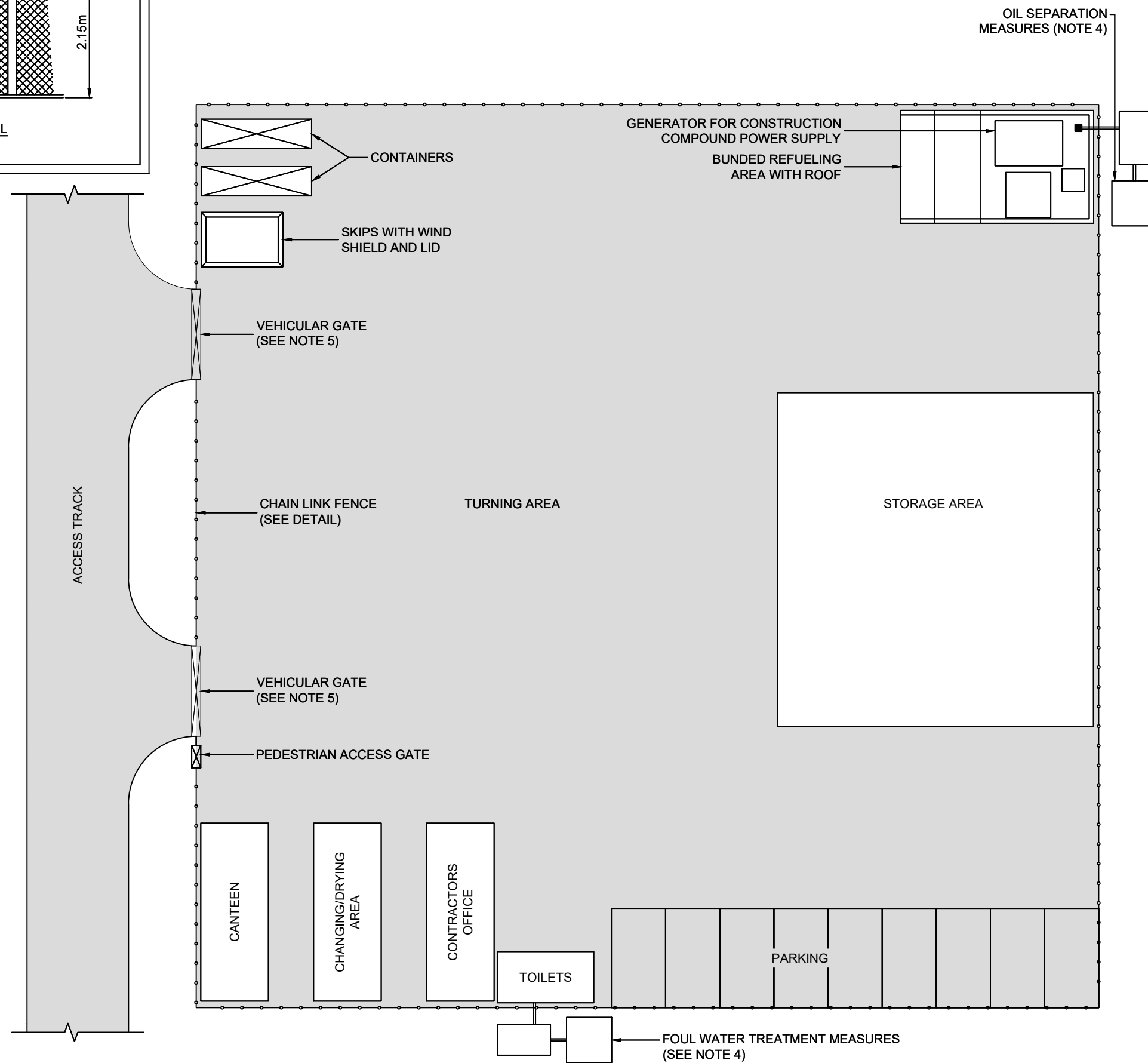

PLAN  
SCALE 1:200

LAYOUT DWG	N/A	T-LAYOUT NO.	N/A
------------	-----	--------------	-----

DRAWING NUMBER	05214-RES-BLD-DR-CO-003	REV	1
----------------	-------------------------	-----	---

SCALE - AS SHOWN @ A3

**ENVIRONMENTAL IMPACT  
ASSESSMENT REPORT 2024**

THIS DRAWING IS THE PROPERTY OF RENEWABLE ENERGY SYSTEMS LTD. AND NO REPRODUCTION MAY BE MADE IN WHOLE OR IN PART WITHOUT PERMISSION